

SERIE UNITIZADA



CARACTERISTICAS

- ▶ Capa anódica en los perfiles de aluminio, ofreciendo mayor protección contra los climas húmedos y salinos.
- ▶ Se puede incluir ventanas proyectantes.

ACABADOS

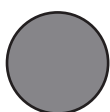

Gris Mate
Anodizado



Negro
Anodizado



Blanco
Pintura
Electrostática

NOTA: Cualquier otro color de acabado, consultar.

ESPESOR DE VIDRIO

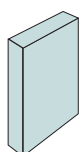

Vidrio monolítico

6mm
8mm
10mm

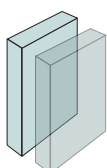

Vidrio laminado

6.38mm
8.38mm
10.38mm

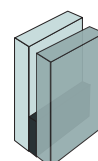

Vidrio insulado

21.5mm
23.5mm
24.3mm
24.7mm
25mm

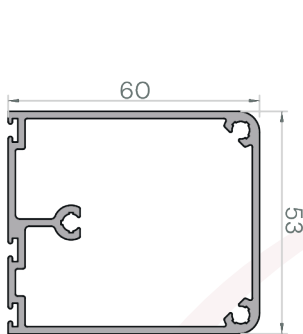

UN-0031



UN-098



UN-105

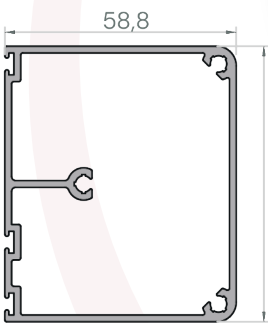

UN-119

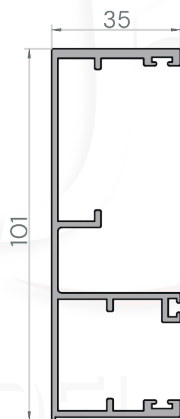

UN-265

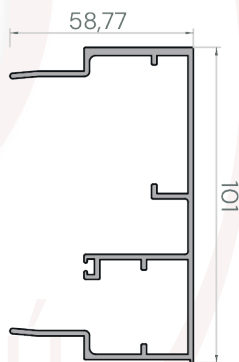

UN-266

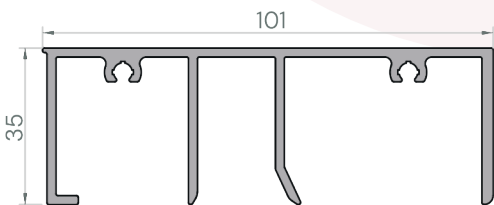

UN-271

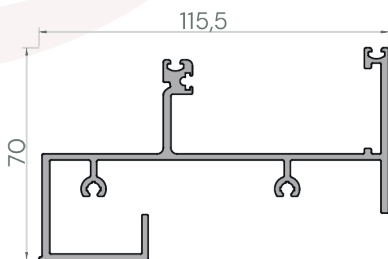

UN-272

CORTE VERTICAL

JR DEL PERÚ

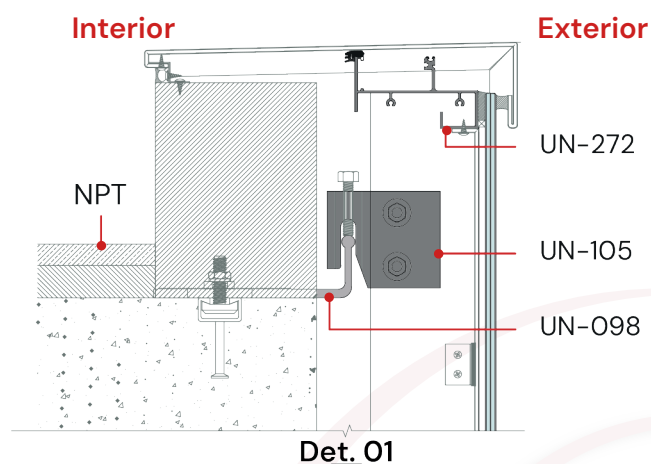

Det. 01

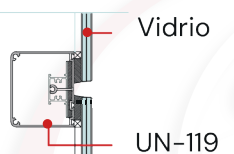

Det. 02

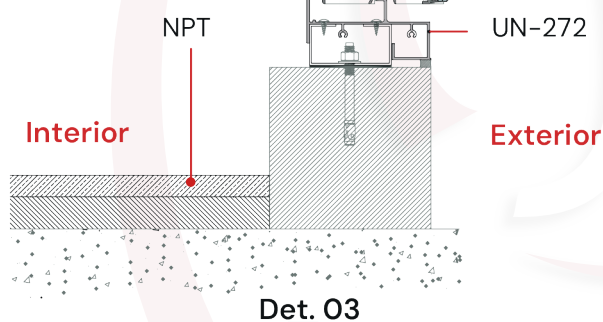

Det. 03

DETALLES

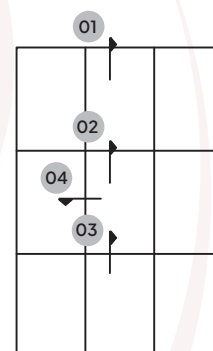

CORTE HORIZONTAL

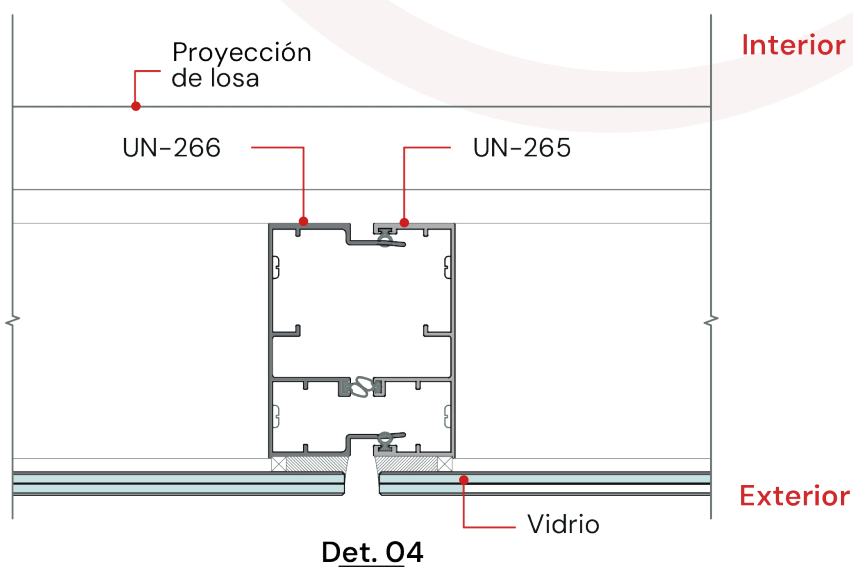

Det. 04



JR DEL PERÚ