

SERIE 35



CARACTERISTICAS

- ▶ Múltiples alternativas de diseño: combinación de 1 hoja, 2 hojas batientes con sobre luz.
- ▶ Capa anódica en los perfiles de aluminio, ofreciendo mayor protección contra los climas húmedos y salinos.

ACABADOS

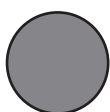

Gris Mate
Anodizado



Negro
Anodizado



Blanco
Pintura
Electrostática

NOTA: Cualquier otro color de acabado, consultar.

ESPESOR DE VIDRIO

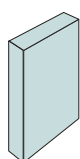

Vidrio monolítico
6mm
8mm

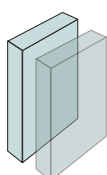

Vidrio laminado
6.38mm
8.38mm

TIPOLOGÍA

JR DEL PERÚ

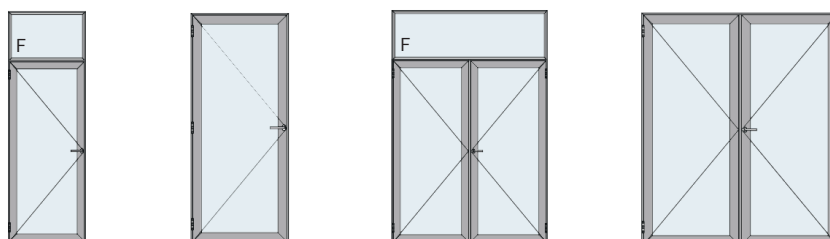

PERFILES

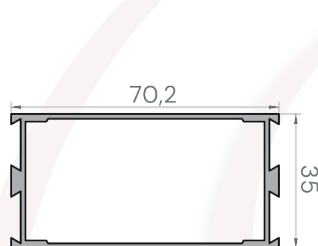

ALN-3501

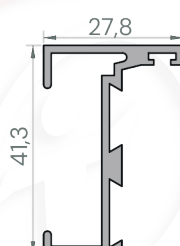

ALN-3502

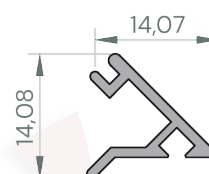

ALN-3503

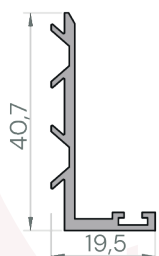

ALN-3509

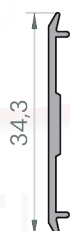

ALN-3506

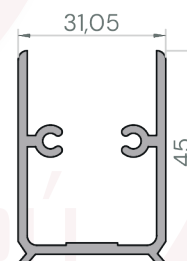

ALN-3510

ACCESORIOS



Bisagras

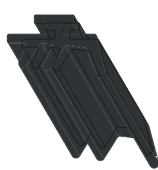

Burlete B-42

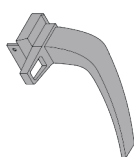

Manija



Burlete
DC-142



Picaporte



Burlete cuña
C-446



Cerradura de
embutir

CORTE VERTICAL

JR DEL PERÚ

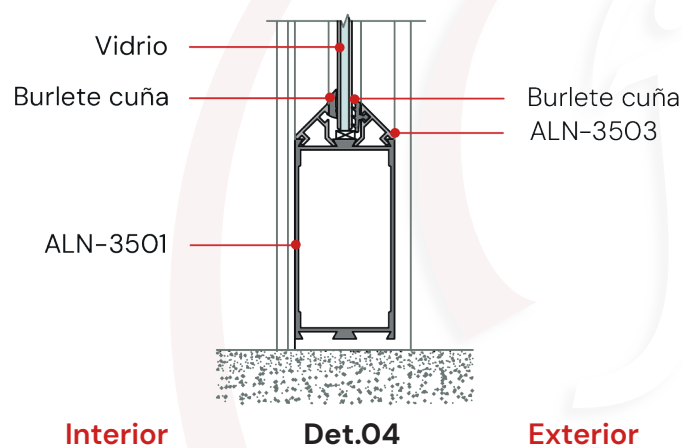
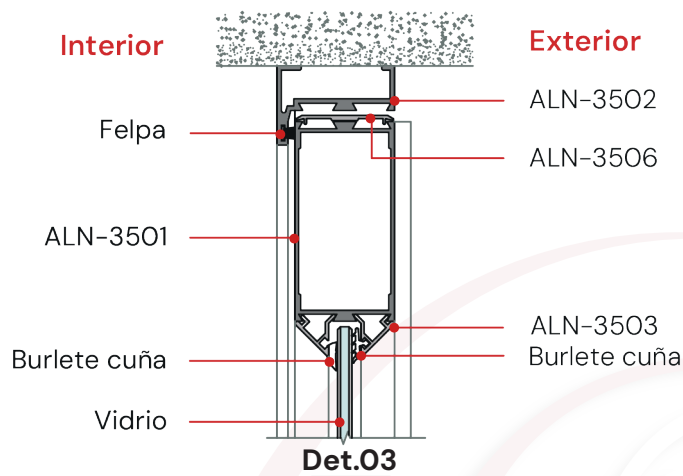

DETALLES

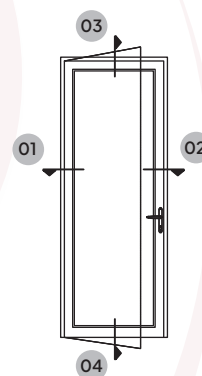

CORTE HORIZONTAL

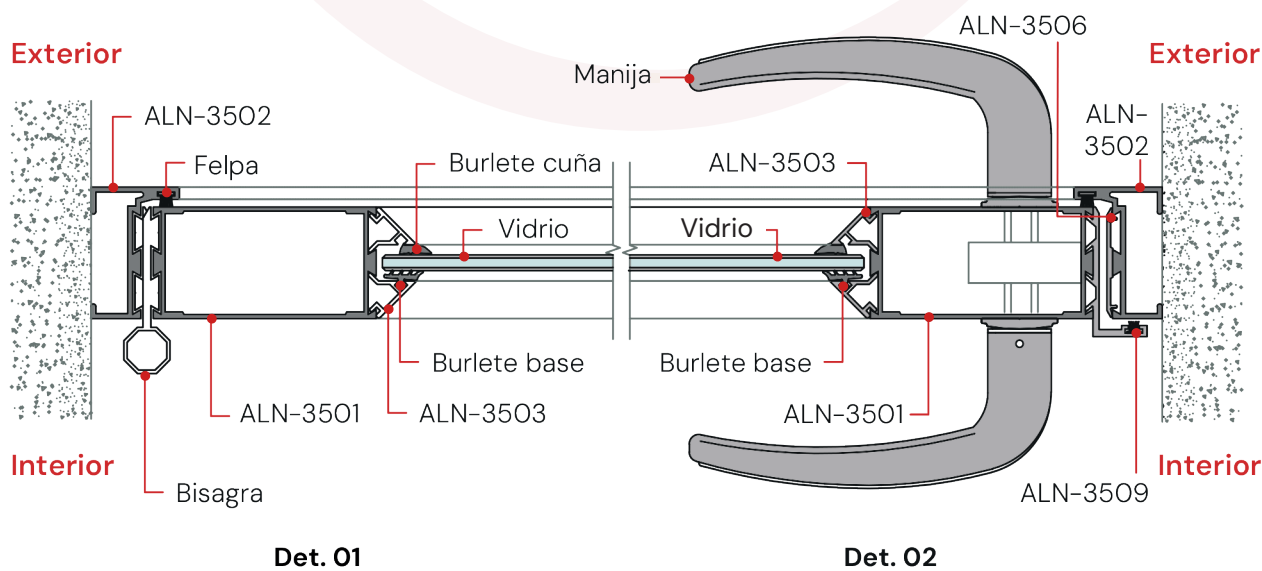



JR DEL PERÚ